

**PSG-CI**  
**1.5m<sub>n</sub>**

# PRECISION GEARS

## 1.5 Module Cast Iron Spur Gear α 20° PA

Quality Grade 7e25 DIN 3961/3967 (AGMA Q10)

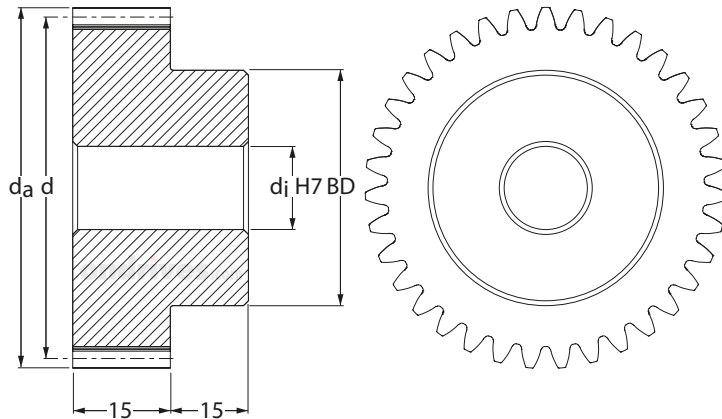

DIN 3967 Tooth Thickness tol.

Part Number	No. of Teeth <i>z</i>	Ref. Dia. <i>d</i>	Tip Dia. <i>d<sub>a</sub></i>	Bore H7 <i>d<sub>j</sub></i>	Max. Bore H7 <i>d<sub>j</sub></i>	Hub Dia. <i>BD</i>
PSG1.5-18CI	18	27.0	30.0	6	12	22
PSG1.5-19CI	19	28.5	31.5	6	12	22
PSG1.5-20CI	20	30.0	33.0	6	12	22
PSG1.5-21CI	21	31.5	34.5	8	14	25
PSG1.5-22CI	22	33.0	36.0	8	14	25
PSG1.5-23CI	23	34.5	37.5	8	14	25
PSG1.5-24CI	24	36.0	39.0	8	14	25
PSG1.5-25CI	25	37.5	40.5	8	14	25
PSG1.5-26CI	26	39.0	42.0	8	14	25
PSG1.5-27CI	27	40.5	43.5	8	14	25
PSG1.5-28CI	28	42.0	45.0	8	14	25
PSG1.5-29CI	29	43.5	46.5	10	20	35
PSG1.5-30CI	30	45.0	48.0	10	20	35
PSG1.5-32CI	32	48.0	51.0	10	20	35
PSG1.5-35CI	35	52.5	55.5	10	20	35
PSG1.5-38CI	38	57.0	60.0	12	25	45
PSG1.5-40CI	40	60.0	63.0	12	25	45
PSG1.5-42CI	42	63.0	66.0	12	25	45
PSG1.5-45CI	45	67.5	70.5	12	25	45
PSG1.5-48CI	48	72.0	75.0	12	25	45
PSG1.5-50CI	50	75.0	78.0	14	30	55
PSG1.5-52CI	52	78.0	81.0	14	30	55
PSG1.5-55CI	55	82.5	85.5	14	30	55
PSG1.5-58CI	58	87.0	90.0	14	30	55
PSG1.5-60CI	60	90.0	93.0	14	30	55
PSG1.5-62CI	62	93.0	96.0	14	30	55
PSG1.5-65CI	65	97.5	100.5	14	30	55
PSG1.5-68CI	68	102.0	105.0	16	40	65
PSG1.5-70CI	70	105.0	108.0	16	40	65
PSG1.5-72CI	72	108.0	111.0	16	40	65
PSG1.5-75CI	75	112.5	115.5	16	40	65
PSG1.5-78CI	78	117.0	120.0	16	40	65
PSG1.5-80CI	80	120.0	123.0	16	40	65
PSG1.5-82CI	82	123.0	126.0	16	40	65
PSG1.5-85CI	85	127.5	130.5	16	40	65
PSG1.5-88CI	88	132.0	135.0	16	40	65
PSG1.5-90CI	90	135.0	138.0	16	40	65
PSG1.5-92CI	92	138.0	141.0	16	40	65
PSG1.5-95CI	95	142.5	145.5	16	40	65
PSG1.5-98CI	98	147.0	150.0	16	40	65

**PSG-CI**  
**1.5m<sub>n</sub>**

# PRECISION GEARS

## 1.5 Module Cast Iron Spur Gear α 20° PA

Quality Grade 7e25 DIN 3961/3967 (AGMA Q10)

Standard Part **PSG** **1.5** **50** **CI**

Modified Part **PSG** **1.5** **50** **CI** **16** **K** **T**

PSG - Precision Spur Gear  
Quality Grade 7e DIN 3961/3967  
Other Quality Grades available.  
See Technical

m<sub>n</sub> Module - Cut with DIN 867 1.25/0.20/1.0  
Ref. Tooth Profile Topping WD = 2.25 x m<sub>n</sub>

Number of Teeth **z**

Standard Material = Cast Iron GG25

**T** = 1 x Tapped hole    **2T** = 2 x Tapped holes  
**P** = 1 x Pin Hole    **PT** = 1 x Pin Hole through  
All threads metric as standard.  
See Technical

**K** - Keyway supplied to  
DIN 6885 - Js9 tolerance.  
See Technical

To specify different bore enter size required  
Example: 16 = 16mm H7 etc  
See Technical

η<sub>z</sub> Meshing Efficiency approx. 98%

Part Number	Backlash (mm)		Inertia kgm <sup>2</sup>	Mass kg	Torque T <sub>2</sub> Nm n <sub>2</sub> 100 Rpm
	j <sub>t,e</sub> (max)	j <sub>t,i</sub> (min)			
PSG1.5-18CI	0.128	0.052	8.30 x 10 <sup>-6</sup>	0.096	2.47
PSG1.5-19CI	0.128	0.052	9.67 x 10 <sup>-6</sup>	0.103	2.61
PSG1.5-20CI	0.128	0.052	1.13 x 10 <sup>-5</sup>	0.110	3.47
PSG1.5-21CI	0.129	0.051	1.47 x 10 <sup>-5</sup>	0.125	3.64
PSG1.5-22CI	0.129	0.051	1.68 x 10 <sup>-5</sup>	0.133	3.82
PSG1.5-23CI	0.129	0.051	1.93 x 10 <sup>-5</sup>	0.142	3.99
PSG1.5-24CI	0.129	0.051	2.21 x 10 <sup>-5</sup>	0.151	4.16
PSG1.5-25CI	0.129	0.051	2.52 x 10 <sup>-5</sup>	0.160	4.34
PSG1.5-26CI	0.129	0.051	2.87 x 10 <sup>-5</sup>	0.170	5.31
PSG1.5-27CI	0.129	0.051	3.27 x 10 <sup>-5</sup>	0.180	5.51
PSG1.5-28CI	0.129	0.051	3.71 x 10 <sup>-5</sup>	0.190	5.72
PSG1.5-29CI	0.129	0.051	5.37 x 10 <sup>-5</sup>	0.246	5.92
PSG1.5-30CI	0.129	0.051	5.92 x 10 <sup>-5</sup>	0.257	6.74
PSG1.5-32CI	0.129	0.051	7.19 x 10 <sup>-5</sup>	0.280	7.19
PSG1.5-35CI	0.171	0.069	9.59 x 10 <sup>-5</sup>	0.318	7.86
PSG1.5-38CI	0.171	0.069	1.54 x 10 <sup>-4</sup>	0.420	8.53
PSG1.5-40CI	0.171	0.069	1.80 x 10 <sup>-4</sup>	0.450	10.05
PSG1.5-42CI	0.171	0.069	2.09 x 10 <sup>-4</sup>	0.481	10.55
PSG1.5-45CI	0.171	0.069	2.62 x 10 <sup>-4</sup>	0.530	11.31
PSG1.5-48CI	0.171	0.069	3.26 x 10 <sup>-4</sup>	0.583	12.06
PSG1.5-50CI	0.171	0.069	4.29 x 10 <sup>-4</sup>	0.697	13.63
PSG1.5-52CI	0.171	0.069	4.86 x 10 <sup>-4</sup>	0.735	14.18
PSG1.5-55CI	0.173	0.067	5.83 x 10 <sup>-4</sup>	0.796	14.99
PSG1.5-58CI	0.173	0.067	6.99 x 10 <sup>-4</sup>	0.861	15.81
PSG1.5-60CI	0.173	0.067	7.86 x 10 <sup>-4</sup>	0.906	17.03
PSG1.5-62CI	0.173	0.067	8.83 x 10 <sup>-4</sup>	0.952	17.60
PSG1.5-65CI	0.173	0.067	1.05 x 10 <sup>-3</sup>	1.024	18.45
PSG1.5-68CI	0.173	0.067	1.33 x 10 <sup>-3</sup>	1.192	19.30
PSG1.5-70CI	0.173	0.067	1.47 x 10 <sup>-3</sup>	1.244	19.87
PSG1.5-72CI	0.173	0.067	1.62 x 10 <sup>-3</sup>	1.298	20.44
PSG1.5-75CI	0.173	0.067	1.87 x 10 <sup>-3</sup>	1.382	21.29
PSG1.5-78CI	0.173	0.067	2.16 x 10 <sup>-3</sup>	1.470	22.14
PSG1.5-80CI	0.173	0.067	2.37 x 10 <sup>-3</sup>	1.530	23.81
PSG1.5-82CI	0.175	0.065	2.60 x 10 <sup>-3</sup>	1.591	24.41
PSG1.5-85CI	0.227	0.097	2.97 x 10 <sup>-3</sup>	1.687	25.30
PSG1.5-88CI	0.227	0.097	3.38 x 10 <sup>-3</sup>	1.785	26.19
PSG1.5-90CI	0.227	0.097	3.68 x 10 <sup>-3</sup>	1.853	26.79
PSG1.5-92CI	0.227	0.097	4.01 x 10 <sup>-3</sup>	1.923	27.38
PSG1.5-95CI	0.227	0.097	4.53 x 10 <sup>-3</sup>	2.029	28.28
PSG1.5-98CI	0.227	0.097	5.10 x 10 <sup>-3</sup>	2.140	29.17

**PSG-CI**  
**2.0m<sub>n</sub>**

# PRECISION GEARS

## 2.0 Module Cast Iron Spur Gear α 20° PA

Quality Grade 7e25 DIN 3961/3967 (AGMA Q10)

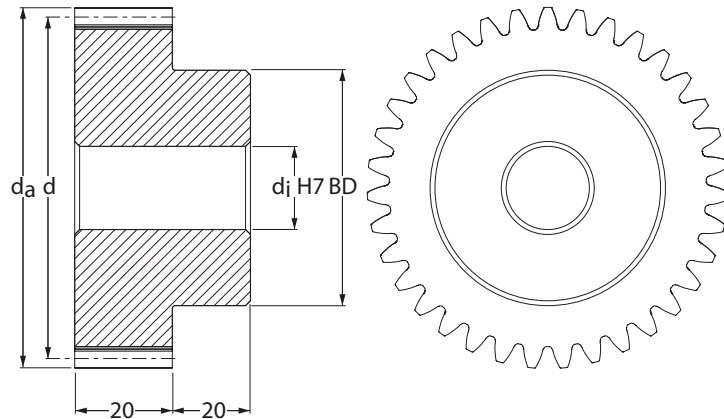

DIN 3967 Tooth Thickness tol.

Part Number	No. of Teeth <i>z</i>	Ref. Dia. <i>d</i>	Tip Dia. <i>d<sub>a</sub></i>	Bore H7 <i>d<sub>j</sub></i>	Max. Bore H7 <i>d<sub>j</sub></i>	Hub Dia. <i>BD</i>
PSG2.0-18CI	18	36	40	10	16	30
PSG2.0-19CI	19	38	42	10	16	30
PSG2.0-20CI	20	40	44	10	16	30
PSG2.0-21CI	21	42	46	12	20	35
PSG2.0-22CI	22	44	48	12	20	35
PSG2.0-23CI	23	46	50	12	20	35
PSG2.0-24CI	24	48	52	12	20	35
PSG2.0-25CI	25	50	54	12	20	35
PSG2.0-26CI	26	52	56	12	20	35
PSG2.0-27CI	27	54	58	12	20	35
PSG2.0-28CI	28	56	60	12	20	35
PSG2.0-29CI	29	58	62	14	25	45
PSG2.0-30CI	30	60	64	14	25	45
PSG2.0-32CI	32	64	68	14	25	45
PSG2.0-35CI	35	70	74	14	25	45
PSG2.0-38CI	38	76	80	14	25	45
PSG2.0-40CI	40	80	84	16	30	55
PSG2.0-42CI	42	84	88	16	30	55
PSG2.0-45CI	45	90	94	16	30	55
PSG2.0-48CI	48	96	100	16	30	55
PSG2.0-50CI	50	100	104	20	40	65
PSG2.0-52CI	52	104	108	20	40	65
PSG2.0-55CI	55	110	114	20	40	65
PSG2.0-58CI	58	116	120	20	40	65
PSG2.0-60CI	60	120	124	20	40	65
PSG2.0-62CI	62	124	128	20	40	65
PSG2.0-65CI	65	130	134	20	40	65
PSG2.0-68CI	68	136	140	20	40	65
PSG2.0-70CI	70	140	144	20	40	65
PSG2.0-72CI	72	144	148	20	40	65

**PSG-CI**  
**2.0m<sub>n</sub>**

# PRECISION GEARS

## 2.0 Module Cast Iron Spur Gear α 20° PA

Quality Grade 7e25 DIN 3961/3967 (AGMA Q10)

Standard Part **PSG** **2.0** **50** **CI**

Modified Part **PSG** **2.0** **50** **CI** **25** **K** **T**

PSG - Precision Spur Gear  
Quality Grade 7e DIN 3961/3967  
Other Quality Grades available.  
See Technical

m<sub>n</sub> Module - Cut with DIN 867 1.25/0.20/1.0  
Ref. Tooth Profile Topping WD = 2.25 x m<sub>n</sub>

Number of Teeth **z**

Standard Material = Cast Iron GG25

**T** = 1 x Tapped hole    **2T** = 2 x Tapped holes  
**P** = 1 x Pin Hole      **PT** = 1 x Pin Hole through  
All threads metric as standard.  
See Technical

**K** - Keyway supplied to  
DIN 6885 - Js9 tolerance.  
See Technical

To specify different bore enter size required  
Example: 25 = 25mm H7 etc  
See Technical

η<sub>z</sub> Meshing Efficiency approx. 98%

Part Number	Backlash (mm)		Inertia kgm <sup>2</sup>	Mass kg	Torque T <sub>2</sub> Nm n <sub>2</sub> 100 Rpm
	j <sub>t,e</sub> (max)	j <sub>t,i</sub> (min)			
PSG2.0-18CI	0.129	-0.051	3.58 x 10 <sup>-5</sup>	0.224	5.53
PSG2.0-19CI	0.129	-0.051	4.15 x 10 <sup>-5</sup>	0.241	5.83
PSG2.0-20CI	0.129	-0.051	4.83 x 10 <sup>-5</sup>	0.258	7.77
PSG2.0-21CI	0.129	-0.051	6.55 x 10 <sup>-5</sup>	0.303	8.15
PSG2.0-22CI	0.129	-0.051	7.45 x 10 <sup>-5</sup>	0.322	8.54
PSG2.0-23CI	0.129	-0.051	8.48 x 10 <sup>-5</sup>	0.342	8.93
PSG2.0-24CI	0.129	-0.051	9.65 x 10 <sup>-5</sup>	0.363	9.32
PSG2.0-25CI	0.129	-0.051	1.10 x 10 <sup>-4</sup>	0.385	9.71
PSG2.0-26CI	0.171	-0.069	1.25 x 10 <sup>-4</sup>	0.408	11.88
PSG2.0-27CI	0.171	-0.069	1.41 x 10 <sup>-4</sup>	0.432	12.33
PSG2.0-28CI	0.171	-0.069	1.60 x 10 <sup>-4</sup>	0.457	12.79
PSG2.0-29CI	0.171	-0.069	2.17 x 10 <sup>-4</sup>	0.561	13.25
PSG2.0-30CI	0.171	-0.069	2.40 x 10 <sup>-4</sup>	0.587	15.07
PSG2.0-32CI	0.171	-0.069	2.94 x 10 <sup>-4</sup>	0.643	16.08
PSG2.0-35CI	0.171	-0.069	3.95 x 10 <sup>-4</sup>	0.733	17.59
PSG2.0-38CI	0.171	-0.069	5.26 x 10 <sup>-4</sup>	0.832	19.09
PSG2.0-40CI	0.171	-0.069	7.03 x 10 <sup>-4</sup>	1.001	23.82
PSG2.0-42CI	0.173	-0.067	8.27 x 10 <sup>-4</sup>	1.075	25.01
PSG2.0-45CI	0.173	-0.067	1.05 x 10 <sup>-3</sup>	1.192	26.80
PSG2.0-48CI	0.173	-0.067	1.32 x 10 <sup>-3</sup>	1.318	28.59
PSG2.0-50CI	0.173	-0.067	1.65 x 10 <sup>-3</sup>	1.509	32.31
PSG2.0-52CI	0.173	-0.067	1.89 x 10 <sup>-3</sup>	1.601	33.60
PSG2.0-55CI	0.173	-0.067	2.30 x 10 <sup>-3</sup>	1.746	35.54
PSG2.0-58CI	0.173	-0.067	2.79 x 10 <sup>-3</sup>	1.898	37.48
PSG2.0-60CI	0.173	-0.067	3.16 x 10 <sup>-3</sup>	2.005	40.37
PSG2.0-62CI	0.175	-0.065	3.56 x 10 <sup>-3</sup>	2.115	41.72
PSG2.0-65CI	0.227	-0.097	4.25 x 10 <sup>-3</sup>	2.286	43.74
PSG2.0-68CI	0.227	-0.097	5.04 x 10 <sup>-3</sup>	2.466	45.76
PSG2.0-70CI	0.227	-0.097	5.64 x 10 <sup>-3</sup>	2.591	47.10
PSG2.0-72CI	0.227	-0.097	6.28 x 10 <sup>-3</sup>	2.719	48.45

**PSG-CI**  
**2.5m<sub>n</sub>**

# PRECISION GEARS

## 2.5 Module Cast Iron Spur Gear α 20° PA

Quality Grade 7e25 DIN 3961/3967 (AGMA Q10)

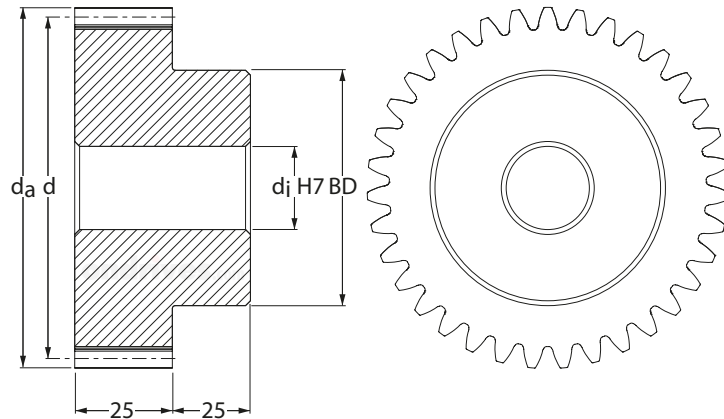

DIN 3967 Tooth Thickness tol.

Part Number	No. of Teeth <i>z</i>	Ref. Dia. <i>d</i>	Tip Dia. <i>d<sub>a</sub></i>	Bore H7 <i>d<sub>j</sub></i>	Max. Bore H7 <i>d<sub>j</sub></i>	Hub Dia. <i>BD</i>
PSG2.5-18CI	18	45.0	50.0	14	18	35
PSG2.5-19CI	19	47.5	52.5	14	18	35
PSG2.5-20CI	20	50.0	55.0	14	18	35
PSG2.5-21CI	21	52.5	57.5	14	18	35
PSG2.5-22CI	22	55.0	60.0	14	18	35
PSG2.5-23CI	23	57.5	62.5	16	25	45
PSG2.5-24CI	24	60.0	65.0	16	25	45
PSG2.5-25CI	25	62.5	67.5	16	25	45
PSG2.5-26CI	26	65.0	70.0	16	25	45
PSG2.5-27CI	27	67.5	72.5	16	25	45
PSG2.5-28CI	28	70.0	75.0	16	25	45
PSG2.5-29CI	29	72.5	77.5	18	35	55
PSG2.5-30CI	30	75.0	80.0	18	35	55
PSG2.5-32CI	32	80.0	85.0	18	35	55
PSG2.5-35CI	35	87.5	92.5	18	35	55
PSG2.5-38CI	38	95.0	100.0	20	40	70
PSG2.5-40CI	40	100.0	105.0	20	40	70
PSG2.5-42CI	42	105.0	110.0	20	40	70
PSG2.5-45CI	45	112.5	117.5	20	40	70
PSG2.5-48CI	48	120.0	125.0	20	40	70
PSG2.5-50CI	50	125.0	130.0	20	40	70
PSG2.5-52CI	52	130.0	135.0	20	40	70
PSG2.5-55CI	55	137.5	142.5	20	40	70
PSG2.5-58CI	58	145.0	150.0	20	40	70

**PSG-CI**  
**2.5m<sub>n</sub>**

# PRECISION GEARS

## 2.5 Module Cast Iron Spur Gear α 20° PA

Quality Grade 7e25 DIN 3961/3967 (AGMA Q10)

Standard Part **PSG** **2.5** **50** **CI**

Modified Part **PSG** **2.5** **50** **CI** **25** **K** **T**

PSG - Precision Spur Gear  
Quality Grade 7e DIN 3961/3967  
Other Quality Grades available.  
See Technical

m<sub>n</sub> Module - Cut with DIN 867 1.25/0.20/1.0  
Ref. Tooth Profile Topping WD = 2.25 x m<sub>n</sub>

Number of Teeth **z**

Standard Material = Cast Iron GG25

**T** = 1 x Tapped hole    **2T** = 2 x Tapped holes  
**P** = 1 x Pin Hole      **PT** = 1 x Pin Hole through  
All threads metric as standard.  
See Technical

**K** - Keyway supplied to  
DIN 6885 - Js9 tolerance.  
See Technical

To specify different bore enter size required  
Example: 25 = 25mm H7 etc  
See Technical

η<sub>z</sub> Meshing Efficiency approx. 98%

Part Number	Backlash (mm)		Inertia kgm <sup>2</sup>	Mass kg	Torque T <sub>2</sub> Nm n <sub>2</sub> 100 Rpm
	j <sub>t,e</sub> (max)	j <sub>t,i</sub> (min)			
PSG2.5-18CI	0.129	- 0.051	1.00 x 10 <sup>-4</sup>	0.401	10.32
PSG2.5-19CI	0.129	- 0.051	1.18 x 10 <sup>-4</sup>	0.433	10.90
PSG2.5-20CI	0.129	- 0.051	1.38 x 10 <sup>-4</sup>	0.467	14.51
PSG2.5-21CI	0.171	- 0.069	1.62 x 10 <sup>-4</sup>	0.503	15.23
PSG2.5-22CI	0.171	- 0.069	1.90 x 10 <sup>-4</sup>	0.540	15.96
PSG2.5-23CI	0.171	- 0.069	2.66 x 10 <sup>-4</sup>	0.676	16.68
PSG2.5-24CI	0.171	- 0.069	3.02 x 10 <sup>-4</sup>	0.717	17.41
PSG2.5-25CI	0.171	- 0.069	3.42 x 10 <sup>-4</sup>	0.760	18.13
PSG2.5-26CI	0.171	- 0.069	3.88 x 10 <sup>-4</sup>	0.804	22.18
PSG2.5-27CI	0.171	- 0.069	4.39 x 10 <sup>-4</sup>	0.851	23.04
PSG2.5-28CI	0.171	- 0.069	4.96 x 10 <sup>-4</sup>	0.899	23.89
PSG2.5-29CI	0.171	- 0.069	6.47 x 10 <sup>-4</sup>	1.071	24.74
PSG2.5-30CI	0.171	- 0.069	7.17 x 10 <sup>-4</sup>	1.123	28.16
PSG2.5-32CI	0.171	- 0.069	8.81 x 10 <sup>-4</sup>	1.231	30.03
PSG2.5-35CI	0.173	- 0.067	1.19 x 10 <sup>-3</sup>	1.407	32.85
PSG2.5-38CI	0.173	- 0.067	1.85 x 10 <sup>-3</sup>	1.843	35.67
PSG2.5-40CI	0.173	- 0.067	2.18 x 10 <sup>-3</sup>	1.980	46.53
PSG2.5-42CI	0.173	- 0.067	2.55 x 10 <sup>-3</sup>	2.124	48.85
PSG2.5-45CI	0.173	- 0.067	3.23 x 10 <sup>-3</sup>	2.354	52.34
PSG2.5-48CI	0.173	- 0.067	4.06 x 10 <sup>-3</sup>	2.599	55.83
PSG2.5-50CI	0.175	- 0.065	4.70 x 10 <sup>-3</sup>	2.771	63.11
PSG2.5-52CI	0.227	- 0.097	5.43 x 10 <sup>-3</sup>	2.950	65.63
PSG2.5-55CI	0.227	- 0.097	6.68 x 10 <sup>-3</sup>	3.233	69.42
PSG2.5-58CI	0.227	- 0.097	8.17 x 10 <sup>-3</sup>	3.531	73.21

**PSG-CI**  
**3.0m<sub>n</sub>**

# PRECISION GEARS

## 3.0 Module Cast Iron Spur Gear α 20° PA

Quality Grade 7e25 DIN 3961/3967 (AGMA Q10)

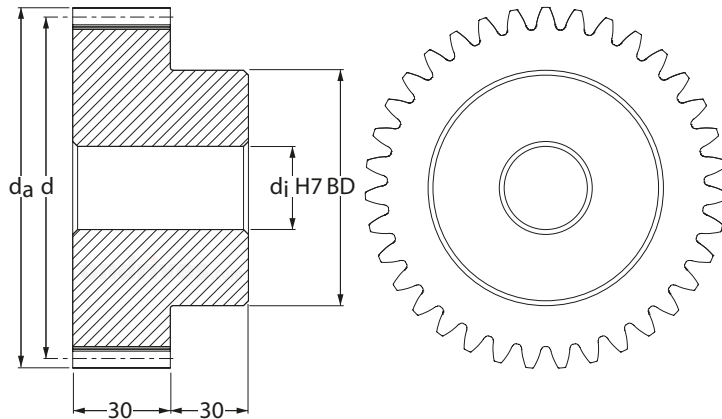

DIN 3967 Tooth Thickness tol.

Part Number	No. of Teeth <i>z</i>	Ref. Dia. <i>d</i>	Tip Dia. <i>d<sub>a</sub></i>	Bore H7 <i>d<sub>j</sub></i>	Max. Bore H7 <i>d<sub>j</sub></i>	Hub Dia. <i>BD</i>
PSG3.0-18CI	18	54	60	14	25	45
PSG3.0-19CI	19	57	63	14	25	45
PSG3.0-20CI	20	60	66	14	25	45
PSG3.0-21CI	21	63	69	16	30	55
PSG3.0-22CI	22	66	72	16	30	55
PSG3.0-23CI	23	69	75	16	30	55
PSG3.0-24CI	24	72	78	16	30	55
PSG3.0-25CI	25	75	81	16	30	55
PSG3.0-26CI	26	78	84	16	30	55
PSG3.0-27CI	27	81	87	16	30	55
PSG3.0-28CI	28	84	90	16	30	55
PSG3.0-29CI	29	87	93	18	40	70
PSG3.0-30CI	30	90	96	18	40	70
PSG3.0-32CI	32	96	102	18	40	70
PSG3.0-35CI	35	105	111	18	40	70
PSG3.0-38CI	38	114	120	18	40	70
PSG3.0-40CI	40	120	126	18	40	70
PSG3.0-42CI	42	126	132	18	40	80
PSG3.0-45CI	45	135	141	18	40	80
PSG3.0-48CI	48	144	150	18	40	80

**PSG-CI**  
**3.0m<sub>n</sub>**

# PRECISION GEARS

## 3.0 Module Cast Iron Spur Gear α 20° PA

Quality Grade 7e25 DIN 3961/3967 (AGMA Q10)

Standard Part **PSG** **3.0** **40** **CI**

Modified Part **PSG** **3.0** **40** **CI** **30** **K** **T**

PSG - Precision Spur Gear  
Quality Grade 7e DIN 3961/3967  
Other Quality Grades available.  
See Technical

m<sub>n</sub> Module - Cut with DIN 867 1.25/0.20/1.0  
Ref. Tooth Profile Topping WD = 2.25 x m<sub>n</sub>

Number of Teeth **z**

Standard Material = Cast Iron GG25

**T** = 1 x Tapped hole    **2T** = 2 x Tapped holes  
**P** = 1 x Pin Hole      **PT** = 1 x Pin Hole through  
All threads metric as standard.  
See Technical

**K**- Keyway supplied to  
DIN 6885 - Js9 tolerance.  
See Technical

To specify different bore enter size required  
Example: 30 = 30mm H7 etc  
See Technical

η<sub>z</sub> Meshing Efficiency approx. 98%

Part Number	Backlash (mm)		Inertia kgm <sup>2</sup>	Mass kg	Torque T <sub>2</sub> Nm n <sub>2</sub> 100 Rpm
	j <sub>t,e</sub> (max)	j <sub>t,i</sub> (min)			
PSG3.0-18CI	0.171	-0.069	2.72 x 10 <sup>-4</sup>	0.766	17.20
PSG3.0-19CI	0.171	-0.069	3.16 x 10 <sup>-4</sup>	0.822	18.16
PSG3.0-20CI	0.171	-0.069	3.67 x 10 <sup>-4</sup>	0.880	24.17
PSG3.0-21CI	0.171	-0.069	5.32 x 10 <sup>-4</sup>	1.091	25.38
PSG3.0-22CI	0.171	-0.069	6.00 x 10 <sup>-4</sup>	1.156	26.58
PSG3.0-23CI	0.171	-0.069	6.78 x 10 <sup>-4</sup>	1.224	27.79
PSG3.0-24CI	0.171	-0.069	7.67 x 10 <sup>-4</sup>	1.295	29.00
PSG3.0-25CI	0.171	-0.069	8.68 x 10 <sup>-4</sup>	1.369	30.21
PSG3.0-26CI	0.171	-0.069	9.81 x 10 <sup>-4</sup>	1.446	36.96
PSG3.0-27CI	0.173	-0.067	1.11 x 10 <sup>-3</sup>	1.527	38.38
PSG3.0-28CI	0.173	-0.067	1.25 x 10 <sup>-3</sup>	1.610	39.81
PSG3.0-29CI	0.173	-0.067	1.72 x 10 <sup>-3</sup>	1.991	41.23
PSG3.0-30CI	0.173	-0.067	1.90 x 10 <sup>-3</sup>	2.080	46.91
PSG3.0-32CI	0.173	-0.067	2.30 x 10 <sup>-3</sup>	2.268	50.04
PSG3.0-35CI	0.173	-0.067	3.07 x 10 <sup>-3</sup>	2.573	54.73
PSG3.0-38CI	0.173	-0.067	4.07 x 10 <sup>-3</sup>	2.905	59.42
PSG3.0-40CI	0.173	-0.067	4.88 x 10 <sup>-3</sup>	3.142	79.93
PSG3.0-42CI	0.227	-0.097	6.17 x 10 <sup>-3</sup>	3.645	83.92
PSG3.0-45CI	0.227	-0.097	7.86 x 10 <sup>-3</sup>	4.041	89.92
PSG3.0-48CI	0.227	-0.097	9.91 x 10 <sup>-3</sup>	4.465	95.91